

SECTION A-A

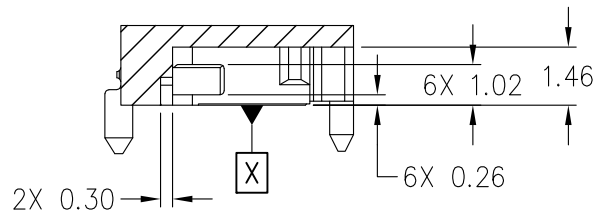

SECTION B-B

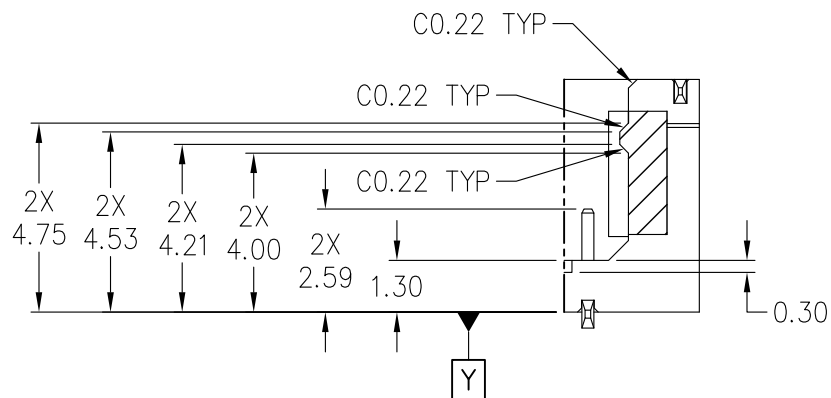

DETAIL A

NOTES:

1. DIMENSIONING AND TOLERANCING CONFORM TO ASME Y14.5-2009.
2. ALL DIMENSIONS ARE IN MM.  
TOLERANCES ON ALL DIMENSIONS  $\pm 0.15$  UNLESS OTHERWISE SPECIFIED.
3. ELECTRICAL CHARACTERISTICS:  
CONTACT CURRENT RATING:  
8.0A MAX PER CONTACT FOR 24AWG (2 POWER PINS).  
PINS 2 THROUGH 5 RATED TO 0.5A EACH MAX.  
INSULATION RESISTANCE: 100M $\Omega$  MIN AT 250 VDC.  
DIELECTRIC WITHSTANDING VOLTAGE: 100 VAC MIN.  
LOW LEVEL CONTACT RESISTANCE: 30M $\Omega$  MAX INITIAL,  $\Delta < 20\text{M}\Omega$
4. MECHANICAL CHARACTERISTICS:  
INSERTION FORCE: 3.0Kgf MAX  
EXTRACTION FORCE: 1.3Kgf MIN INITIAL, 1.1Kgf MIN.AFTER DURABILITY.  
DURABILITY: 30 MATING CYCLES.
5. OPERATING TEMPERATURE: -40°C ~ +95°C.
6. THE PRODUCTS SHOULD MEET THE R.O.H.S. REQUIREMENT.
7. RECOMMENDED PROCESS CONDITION: PEAK TEMPERATURE 260°C, 10~20S.
8. RECOMMENDED PCB THICKNESS: 1.0MM.
9. RECOMMENDED COPPER FOIL AREA: 300MM<sup>2</sup> MIN, THICKNESS: 2 OZ.

10. REFERENCE PCB FOOTPRINT.

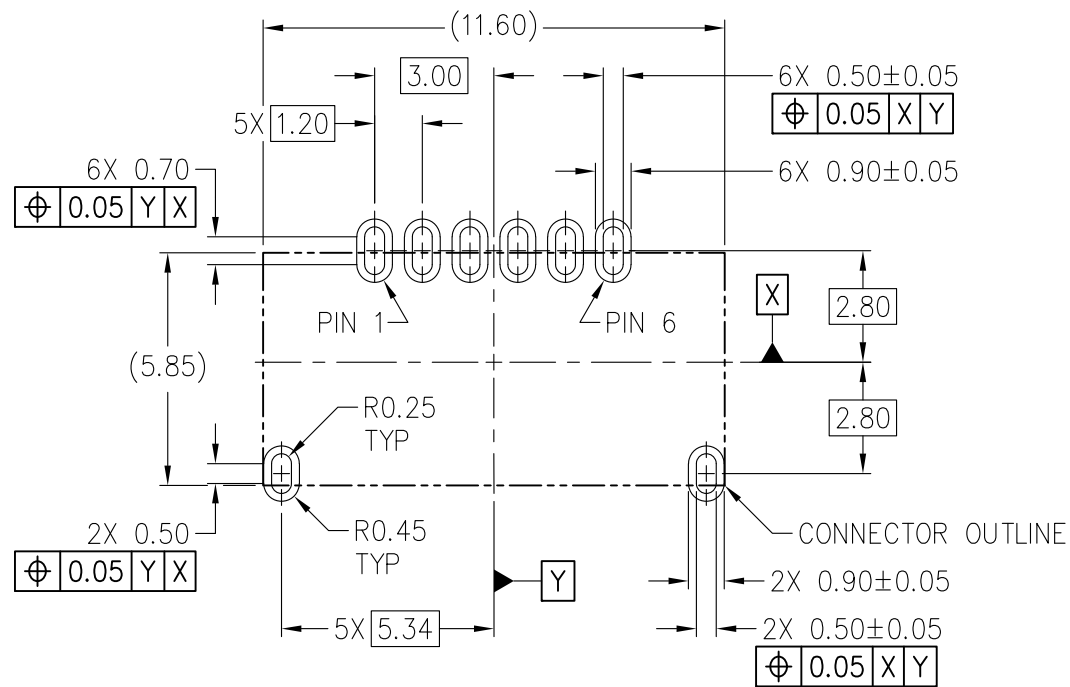

RECOMMENDED PCB LAYOUT

STP (3D) FILE RECORD  
3D FILE NAMES MAY EXCEED LENGTH REQUIREMENTS FOR SOME SOFTWARE TOOLS.

STP FILE NAME	DATE	ITEM NUMBER
SO-026A-PSXC-P6_l1p2-R11p6x5p85Z2p0-R0p3x0p3IH1p16	OCT 2021	14-198

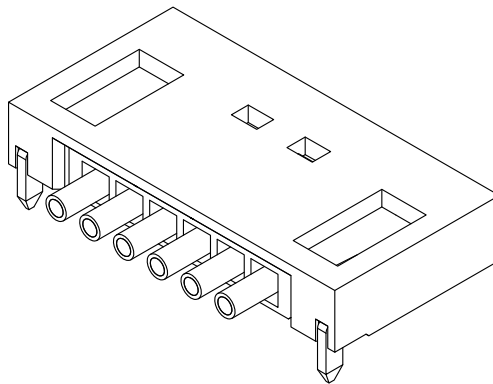

## TASK GROUP CONTRIBUTORS

FOXCONN INTERCONNECT TECHNOLOGY, LTD. (FIT)  
HEWLETT PACKARD ENTERPRISE COMPANY  
LOTES CO., LTD.  
LUXSHARE-ICT, INC.

# CHANGE RECORD

IF THE CHANGE INVOLVES ANY WORDS ADDED OR DELETED (EXCLUDING DELETION OF ACCIDENTALLY REPEATED WORDS), THE CHANGE IS TO BE INCLUDED BELOW. PUNCTUATION CHANGES MAY OR MAY NOT BE INCLUDED.

INITIAL ISSUE: A	DATE: OCTOBER	ITEM NUMBER: 14-198
------------------	---------------	---------------------

CHANGE RECORD HISTORY:
------------------------

ISSUE: -	DATE: -	ITEM NUMBER: -
----------	---------	----------------

LOCATION:	CHANGED FROM:	CHANGED TO: